

MEDIUM VELOCITY GAS TILE BURNERS

JMGT-050 **JMGT-070**
JMGT-100 **JMGT-120**
JMGT-125 **JMGT-130**
JMGT-140 **JMGT-150**
JMGT-200

| GENERAL INFORMATIONS |

The "JMGT" gas burner series is a blown-air burner which can operate with natural gas, LPG, lean gas and gas with low calorific power (on request). It was designed for the installation in all the process in which it is necessary to obtain a deeply oxidizing combustion to limit working temperature. The completely automatic working allows on-off regulations, high/low flame, air/gas modulating. The last allows to obtain max.-min. regulation ratio until 15:1. The maximum thermal potentiality is 2,675kW (2,300,000kcal/h) while the minimum potentiality can come up to 5.8kW(5,000kcal/h). Combustion air temperature required for this burner can change from room temperature until 300°C. A particular care has been dedicated to CO and NOx emissions produced by combustion process, these elements are lower than limits required by EN 676 regulations. Burner structure is painting casting, the body is of iron, the bottom of aluminum, the parts in contact with flame of refractory steel and Nickel Chrome alloys. The burner has ignition and flame revelation electrodes, pressure switch to measure air and gas instantaneous flows, flame indicating light.

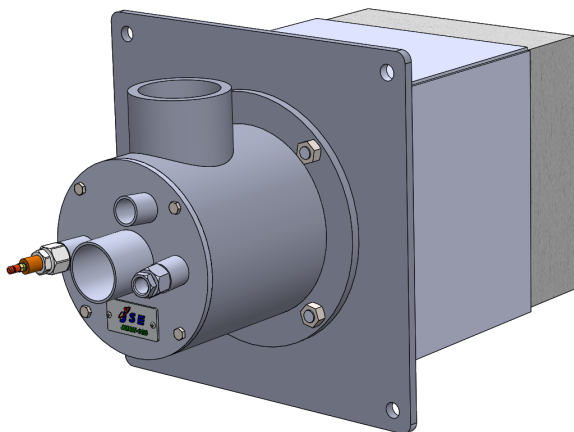

FEATURES

- Direct spark ignition, ionization flame detection electrode or U.V. cell.
- For natural gas or LPG, other gaseous fuel on request.
- Max.-min. ratio 15:1.
- Easy to install, to start, to operate.

APPLICATIONS

- All types of kilns, suitable for oxidative, stoichiometric or reducing combustion.
- Ceramic, Bricks, Refractory:
 - Roller kilns, Tunnel kilns, Intermittent kilns, Melting kilns.
 - Continuous and Intermittent Dryers.
- Iron metallurgic Industry.
- Surfaces Treatment.
- Glass : Hardening ovens
- Printing and Packing : Air Heaters for Rotogravures, Flexographic and Coupling and adhesive coating Machines.
- Food : Cereal Dryers, Roasters.
- Drying Tobacco.

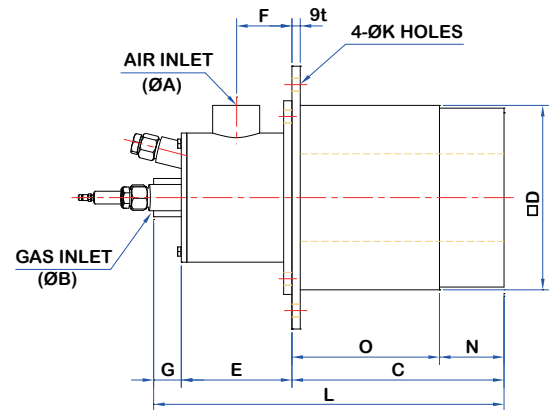
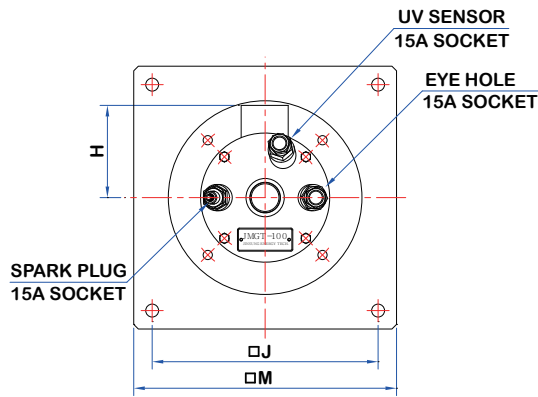

| DIMENSIONS |

MODEL	A	B	C	D	E	F	G	H	J	K	M	O	N	L
JMGT-050	25A	20A	190	170	100	50	30	80	220	4-Ø12	250	130	70	320
JMGT-070	32A	25A	230	200	120	60	30	100	245	4-Ø14	285	160	70	380
JMGT-100	40A	25A	230	200	120	60	30	100	245	4-Ø14	285	160	70	380
JMGT-120	50A	32A	240	240	140	80	35	120	290	4-Ø16	330	170	70	420
JMGT-125	65A	40A	320	280	170	90	35	140	330	4-Ø18	370	245	75	525
JMGT-130	80A	40A	320	280	180	100	40	150	330	4-Ø18	380	245	75	540
JMGT-140	100A	50A	350	320	250	140	40	210	370	4-Ø18	420	270	80	640
JMGT-150	150A	65A	350	350	320	160	40	240	400	4-Ø18	450	270	80	710
JMGT-200	200A	80A	390	380	380	210	40	260	430	4-Ø18	480	310	80	810

| TECHNICAL DATA |

MODEL	NOMINAL CAPACITY		AIR PRESSURE @15 °C (mb)*	AIR VOLUME @15 °C (Nm ³ /hr)	GAS PRESSURE (mb)*	MAXIMUM CAPACITY	
	(×10 ³ kcal/hr)	(kW)				(×10 ³ kcal/hr)	(kW)
JMGT-050	30	34	65	65	30	50	58
JMGT-070	40	46	65	91	30	70	81
JMGT-100	80	93	65	156	30	120	139
JMGT-120	150	174	65	260	30	200	232
JMGT-125	200	232	65	327	30	250	290
JMGT-130	300	348	65	507	30	350	406
JMGT-140	500	581	65	806	35	600	697
JMGT-150	1,000	1,162	65	1,755	35	1,300	1,511
JMGT-200	2,000	2,300	65	3,015	35	2,300	2,675

The above mentioned performance data are described at their maximum power.
Pressure showed are guidelines only.

* Stoichiometric conditions.
Performance data and dimensions are guidelines only.

The descriptions and specifications are subject to change without notice.