

# HIGH MOMENTUM GAS BURNERS

**JGB-100**

**JGB-200**

**JGB-300**

**JGB-400**

**JGB-500**

**JGB-800**

**JGB-1200**

## | GENERAL INFORMATIONS |

The "JGB" gas burner series is a blown-air burner which can operate with natural gas, LPG, lean gas and gas with low calorific power (on request). It was designed for the installation in all the process in which it is necessary to obtain a deeply oxidizing combustion to limit working temperature. The completely automatic working allows on-off regulations, high/low flame, air/gas modulating. The last allows to obtain max.-min. regulation ratio until 10:1. The maximum thermal potentiality is 15,930kW (13,700,000kcal/h) while the minimum potentiality can come up to 5.8kW(1,200kcal/h). Combustion air temperature required for this burner can change from room temperature to 450°C. A particular care has been dedicated to CO and NOx emissions produced by combustion process, these elements are lower than limits required by EN 676 regulations. Burner tile is made from refractory – high alumina castable, it could be used up to 1,650°C.

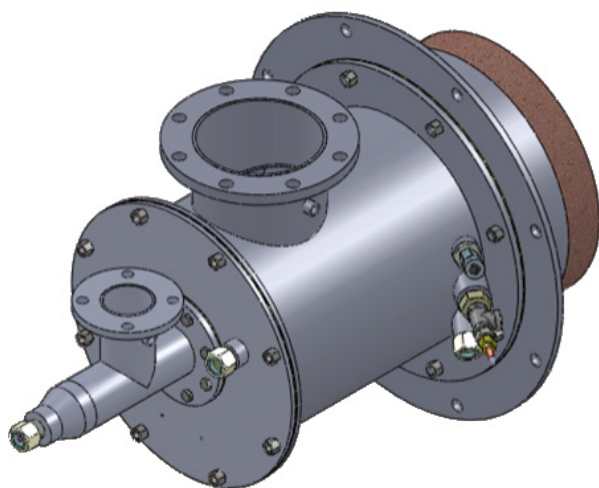

## FEATURES

- Direct spark ignition, ionization flame detection electrode or U.V cell.
- For natural gas or LPG, other gaseous fuel on request.
- Max.-min. ratio 10:1.
- Easy to install, to start, to operate.

## APPLICATIONS

- All types of kilns, suitable for oxidative, stoichiometric or reducing combustion.
- Ceramic, Bricks, Refractory:
  - Roller kilns, Tunnel kilns, Intermittent kilns, Melting kilns.
  - Continuous and Intermittent Dryers.
- Iron metallurgic Industry.
- Surfaces Treatment.
- Glass : Hardening ovens.
- Hot Gas Generator.
- Incinerator.
- Industrial waste treatment.

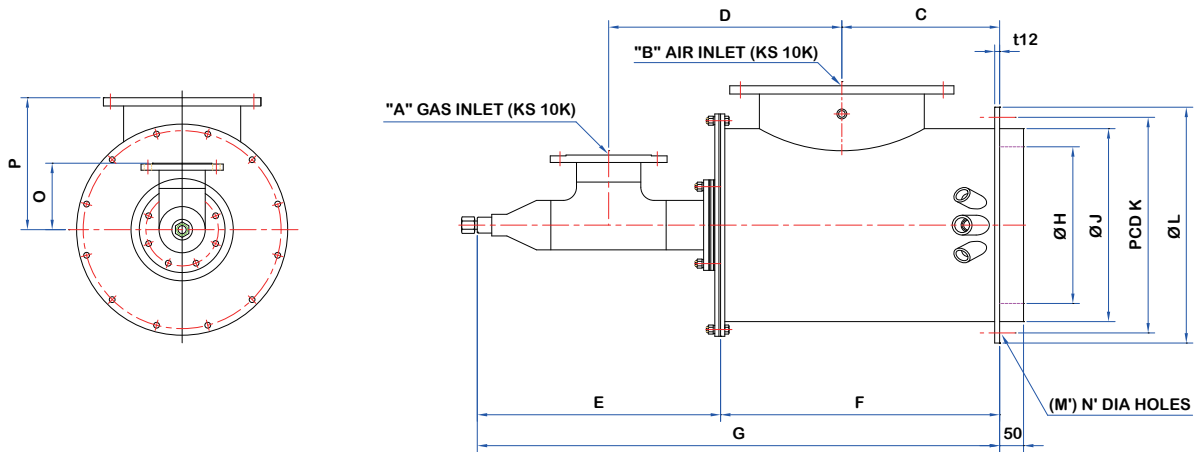

## | DIMENSIONS |

Q: PILOT HOLES R: SITE HOLES

MODEL	A	B	C	D	E	F	G	H	J	K	L	M	N	O	P	Q	R
JGB-100	80A	150A	320	300	404	450	857	250	400	510	560	8	17	180	300	32A	25A
JGB-200	80A	200A	320	350	415	485	900	260	400	510	560	8	17	200	320	32A	25A
JGB-300	100A	250A	350	380	460	530	990	350	450	530	590	8	17	200	340	32A	25A
JGB-400	100A	300A	400	380	460	530	990	350	500	585	640	12	17	200	380	32A	25A
JGB-500	125A	350A	450	500	520	600	1120	400	550	640	710	12	17	200	400	32A	25A
JGB-800	125A	400A	450	550	600	750	1350	490	610	680	740	12	19	250	450	32A	25A
JGB-1200	150A	450A	460	550	600	760	1360	550	660	740	800	12	19	280	450	32A	25A

## | TECHNICAL DATA |

MODEL	Combustion Air		Fuel Gas (LPG)		Fuel Gas (LNG)		Fuel Gas (COG)		Capacity	Flame	
	Pressure	Flow	Pressure	Flow	Pressure	Flow	Pressure	Flow	20% Excess Air	Length	Diameter
	(mb)	(Sm <sup>3</sup> /hr)	(mb)	(Sm <sup>3</sup> /hr)	(mb)	(Sm <sup>3</sup> /hr)	(mb)	(Sm <sup>3</sup> /hr)	(x10 <sup>3</sup> kcal/hr)	(mm)	(mm)
JGB-100	35	1,456.2	11	53.5	17.5	126.3	22	272.7	1,200	2,280	610
JGB-200	35	2,791.0	11	102.4	17.5	242.1	22	522.7	2,300	2,740	1,070
JGB-300	35	4,004.5	11	147.0	17.5	347.4	22	750.0	3,300	3,660	1,520
JGB-400	35	5,096.6	11	187.1	17.5	442.1	22	954.5	4,200	3,960	1,670
JGB-500	35	6,431.4	11	236.1	17.5	557.9	22	1,204.5	5,300	4,560	1,750
JGB-800	53	10,071.8	11	369.7	17.5	873.7	22	1,886.4	8,300	5,860	1,850
JGB-1200	53	16,624.6	11	610.2	17.5	1,442.1	22	3,223.6	13,700	7,500	1,960

The above mentioned performance data are described at their maximum power.  
Pressure showed are guidelines only. Gas pressures are refer to Natural gas.

\* Stoichiometric conditions.

Performance data and dimensions are guidelines only.

The descriptions and specifications are subject to change without notice.