

NOZZLE MIX OIL BURNERS

JOB-040

JOB-070

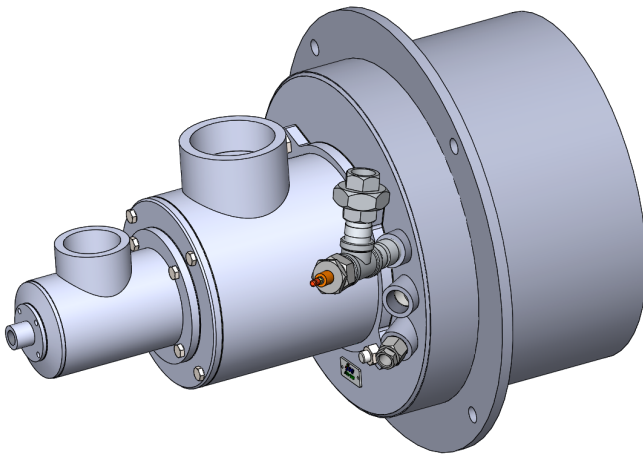

FEATURES

- Choice of a low velocity or medium velocity burner.
- Long lifetime with Refractory (castable) on working temperature up to 1200 °C
- Available for Preheated Air operation up to 350 °C .
- For Kerosine, Diesel oil.
- Fuel Capacity based on 42,000 ~ 682,000 kcal/hr oil and 20% excess air.
- Available automatic gas Pilot burner or manual ignition.

APPLICATIONS

- Heat treatment.
- Heating up.
- Al-melting.
- Steel reheat furnace.
- Rotary dryer.

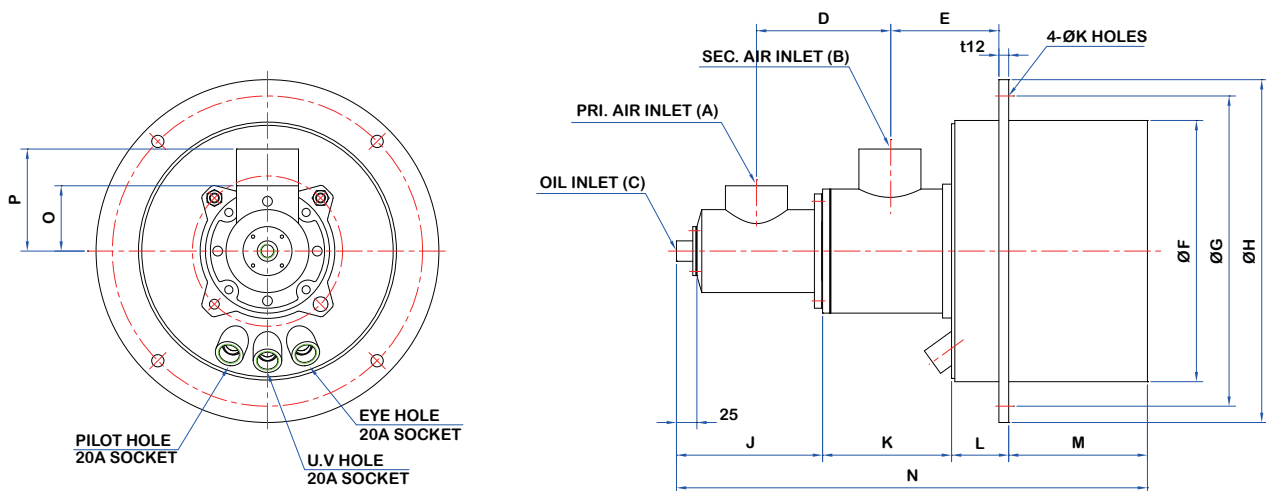

| DIMENSIONS |

MODEL	A	B	C	D	E	F	G	H	J	K	L	M	N	O	P
JOB-040	50A	50A	15A	165	146	320	380	420	180	160	70	170	580	80	125
JOB-070	50A	80A	15A	165	186	360	420	460	180	200	70	180	630	80	150

| TECHNICAL DATA |

MODEL	AIR PRESSURE@ 70mb			OIL CAPACITY (liter/hr)
	PRIMARY AIR (m ³ /hr)	SECONDARY AIR (m ³ /hr)	CAPACITY (x 10 ³ kcal/hr)	
JOB-040	48	447	341	40
JOB-070	96	924	682	80

Fuel Capacity based on 8,530 kcal/liter oil and 20% excess air.

Air pressure is "total pressure" measured 6 pipe diameters from burner.

Oil Pressure should be at least 0.35-0.7 bar at the burner.

Capacities for preheated air operation will differ from those shown.

The descriptions and specifications are subject to change without notice.